

CENTRAL VILLAS - CLUB HOUSE



BUA- 12000 SFT

MAIN CLUB



reception lobby



g r o u n d f l o o r p l a n



coffee lounge



ground floor plan



pool deck



swimming pool

ground floor plan



outdoor party area

stage



ground floor plan



gymnasium

aerobics



first floor plan



sauna

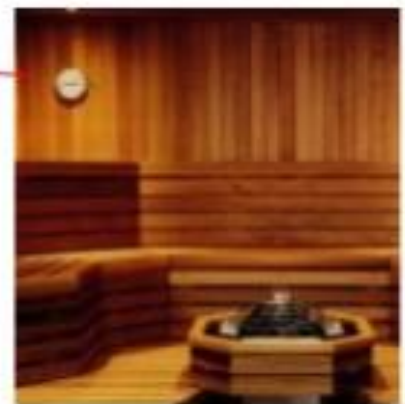

toilet



first floor plan



sauna

toilet

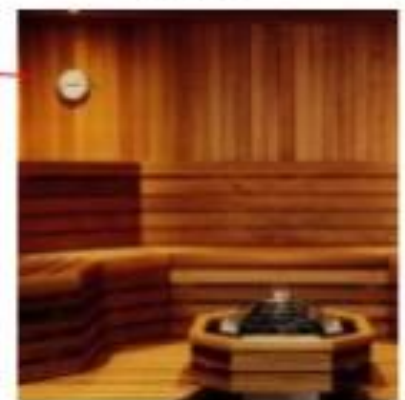

first floor plan



home theatre



second floor plan



reading room

second floor plan



ladies lounge

s e c o n d floor plan

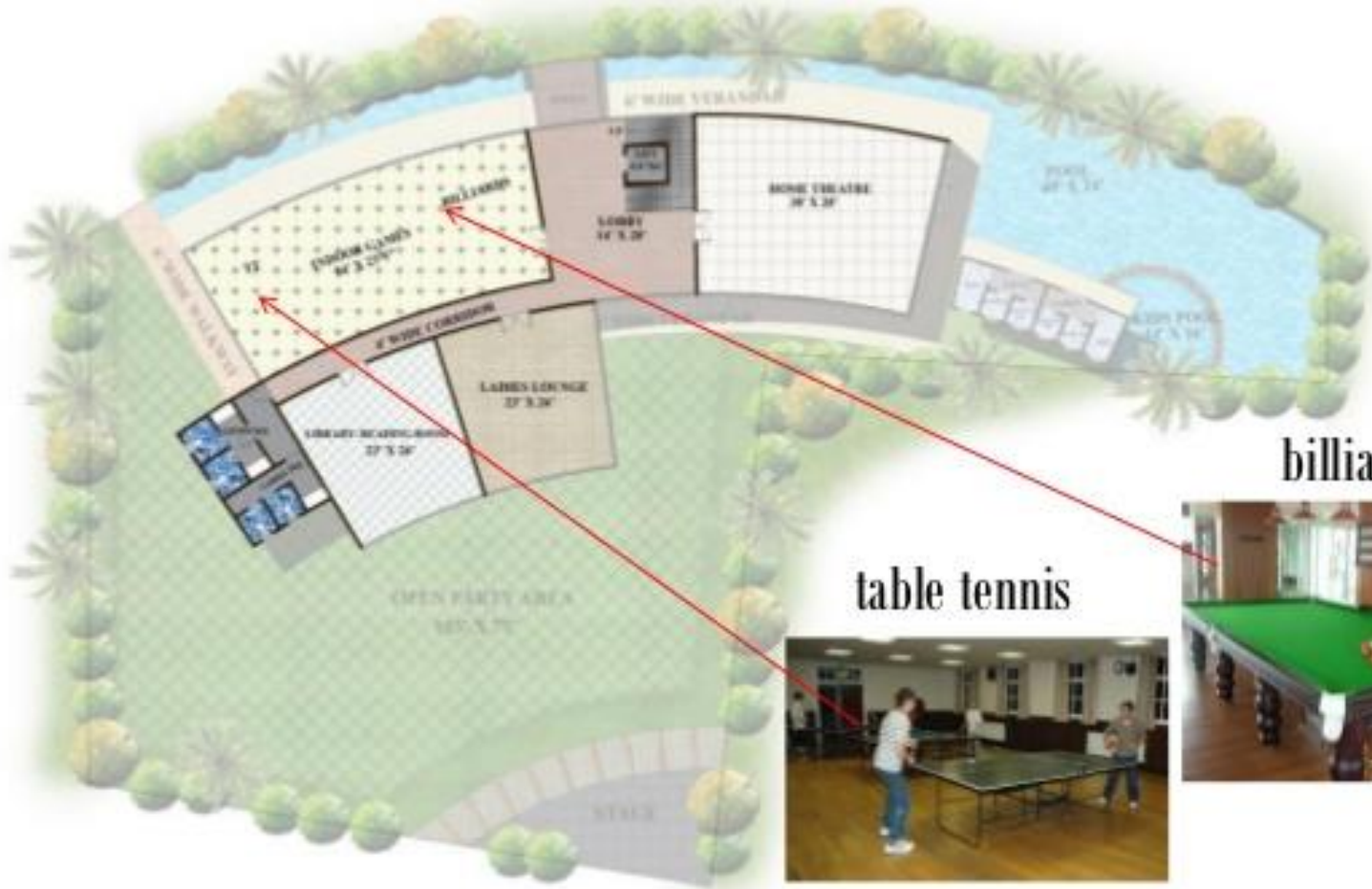

billiards



table tennis



second floor plan

